

# WingBee for iPhone OS (Full edition)

## Quick start guide

---

### Table of Contents

<a href="#">Table of Contents.....</a>	<a href="#">1</a>
<a href="#">Short description.....</a>	<a href="#">2</a>
<a href="#">Installation procedure.....</a>	<a href="#">2</a>
<a href="#">Configuration procedure.....</a>	<a href="#">4</a>
<a href="#">Usage instructions.....</a>	<a href="#">9</a>
<a href="#">Usage of remote data.....</a>	<a href="#">12</a>
<a href="#">Account modifications.....</a>	<a href="#">17</a>

## Short description

This application allows you to use your favourite iPhone on Web3Tel network and for any Web3Tel Distributors. It provides:

- callback functionality for Web3Tel service (or any other services powered by Web3Tel, e.g. [www.e1tele.com](http://www.e1tele.com), [www.comfytel.com](http://www.comfytel.com)) customers by using data connectivity (GPRS/3G).
- Call-in functionality Web3Tel service (or any other services powered by Web3Tel, e.g. [www.e1tele.com](http://www.e1tele.com), [www.comfytel.com](http://www.comfytel.com)) customers by using service specific access numbers
- Synchronization with web-based contacts, fast callback entries, web favorites and callhistory (recent calls records).

This application is seamlessly integrated in your phone OS and does not change any user experience.

You can initiate a “smart call”:

- using user interface that is the same list of contacts as a standard iPhone “Contacts” application;
- Dial pad that integrated inside application
- Recent calls, web-based contacts, web favourites and fast callback entries.

## Installation procedure

WingBee for iPhone OS can be freely downloaded from Apple Store, provided by Apple. You just need to open “App Store” application on your iPhone and search for WingBee application.

After successful installation you will see “WingBee” in your device application list:

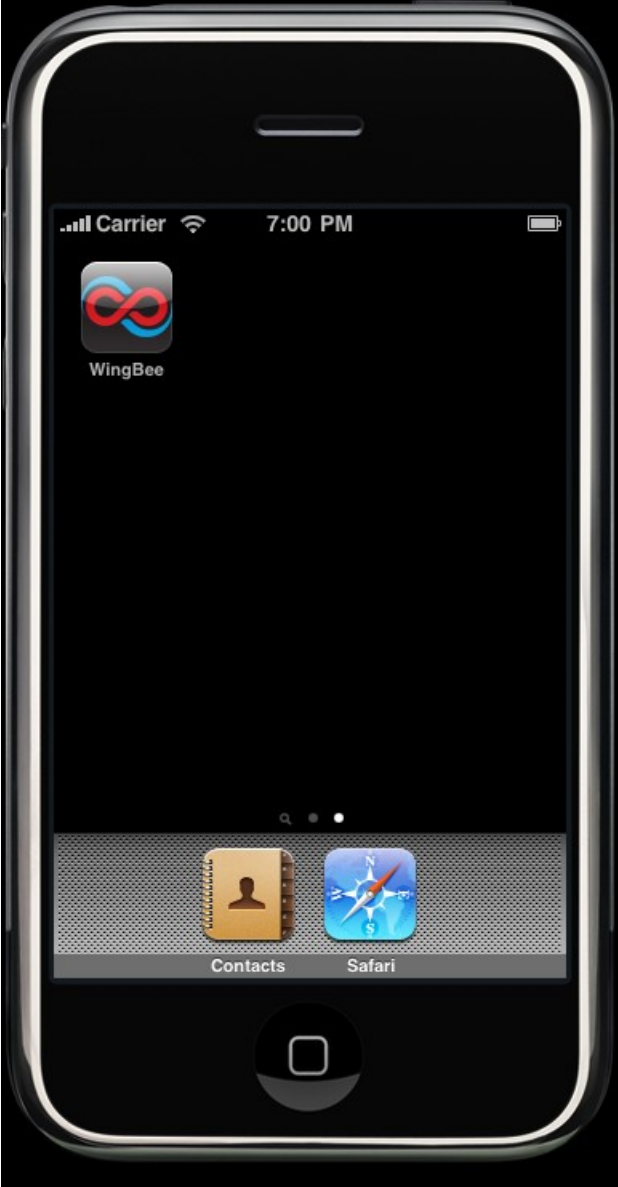

## Configuration procedure

After you install the WingBee you can use it right away for making long distance call.

To use an application you should have an account with one of Web3Tel Distributors.

After you first start an application you will see the list of available Distributors:



If you don't see yours Distributor in the list press update button (top-right circle like button) and the device will update the list of available Distributors.

After you select the Distributor you should enter your account credential and phone number of device:

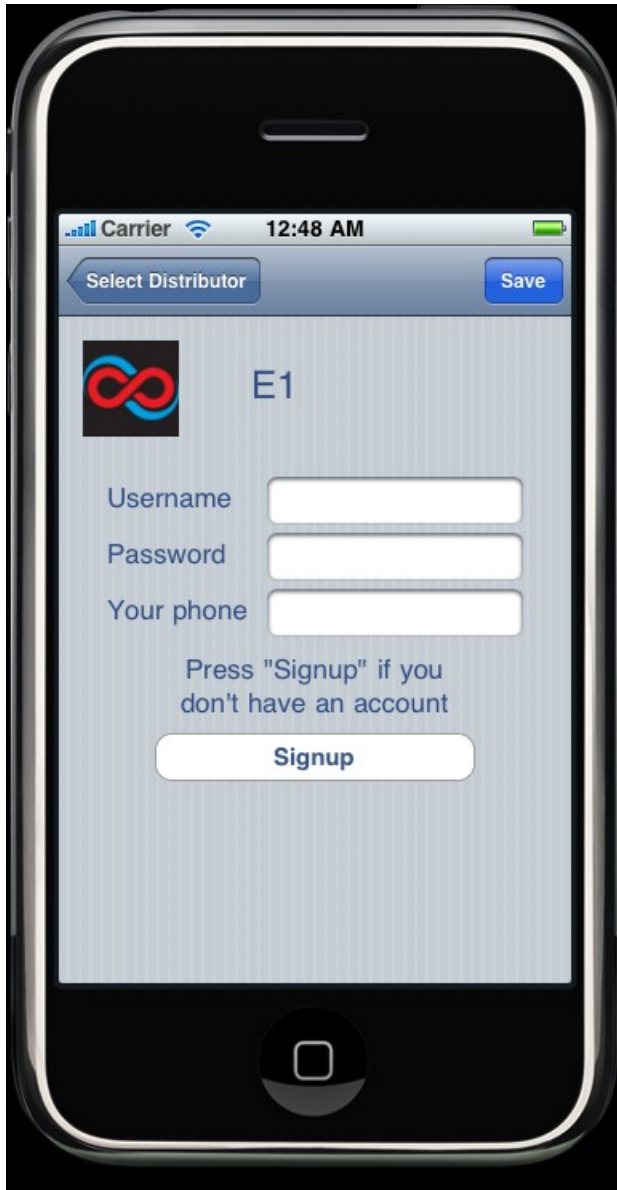

If you don't have an account with selected Distributor you can press "Signup" button and it will bring correspondent Distributor's website where you can open an account.

After you have entered credentials and your phone number you should press "Save" button:

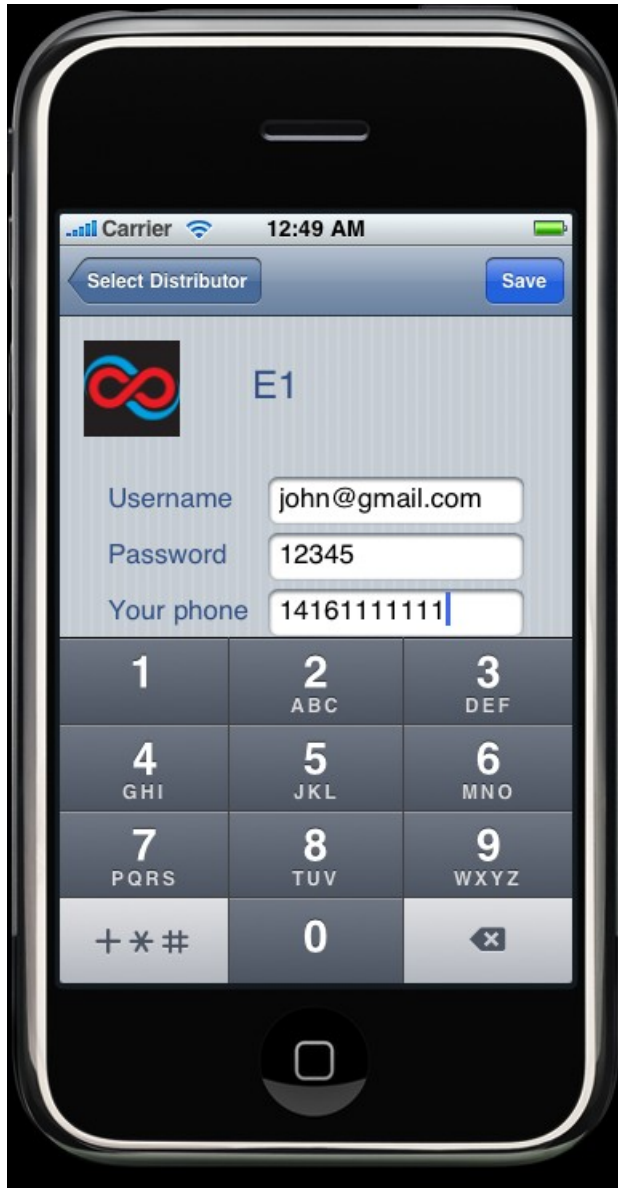

Now you will see the main application window that has several tabs and can make a call right away:

- "Speed Dial" – contains the list of speeddial from your web account that can be downloaded through update procedure;
- "Recent Calls"– contains the list of recent call from your web account that can be downloaded through update procedure;
- "Contacts" – list of your local device contacts;
- "Dial pad" – dialing pad for entering destination phone number;

In "More" you will have:

- “Web Contacts” - contains the list of web based contacts from your web account that can be downloaded through update procedure;
- “Account” – account control page (see later).

If you have not selected your Distributor you will not be able to make a call:

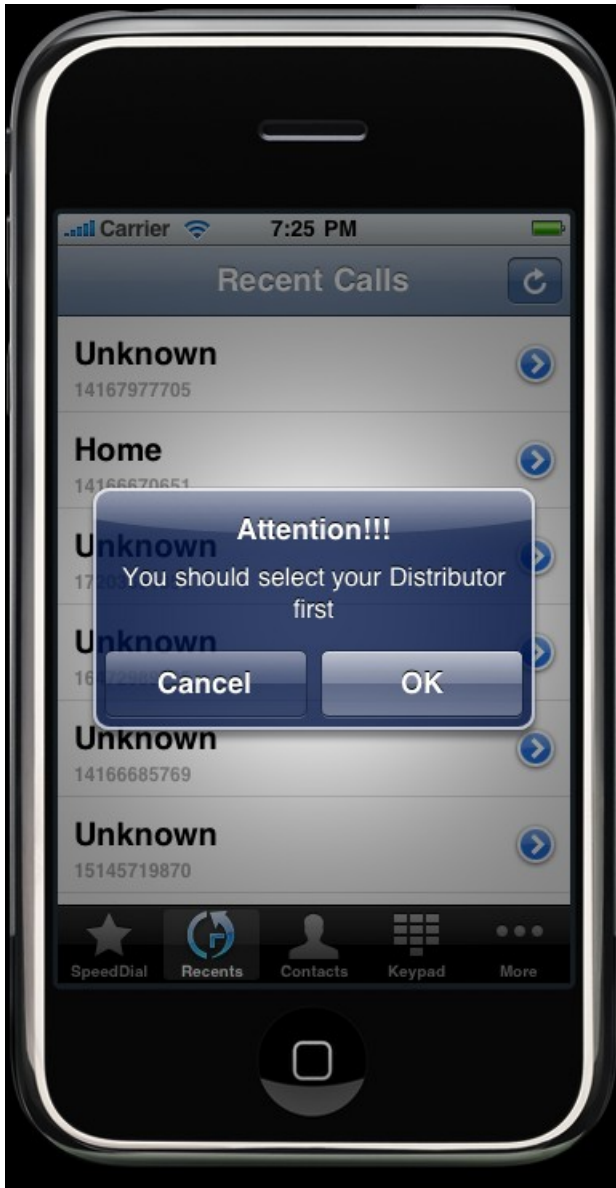

Also if you have not defined your phone number an application will ask to do it next time when you are trying to make a call:



## Usage instructions

As we have mentioned before WingBee seamlessly integrated in your phone. This application shares the same Contacts database as standard iPhone “Contacts” application and brings power of your web account to your mobile device:

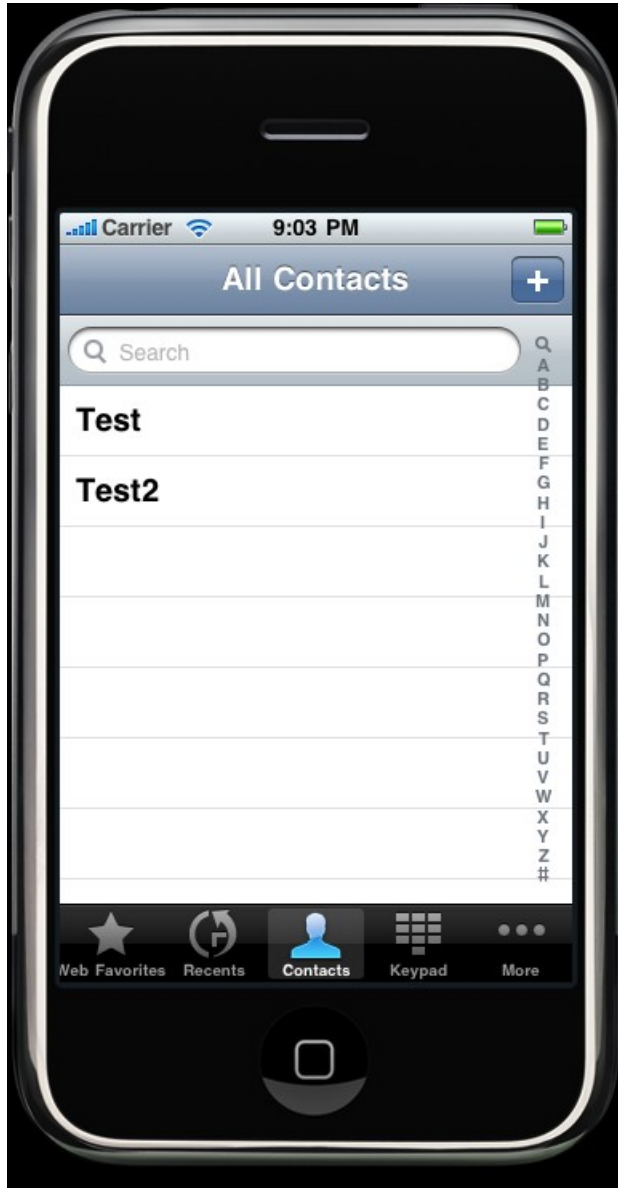

At this moment WingBee support 3 call invocation methods:

- Data initiated callback through available data channel
- Cell initiated callback through the call to mapped callback numbers (fast callback)
- Call-in method

The main call invocation method for this application is a callback initiated through data channel. This mode of call invocation will be set by default.

You need just click on your contact's phone number from the list of local or Web contacts or recent calls to initiate a callback.

After request has being accepted by the server Web3Tel network will initiate a call to you originated phone (in most cases your current mobile phone with WingBee).

After you accept this incoming call the server will connect you with a destination party.

Fast callback panel provides the list of contacts that mapped to specific callback numbers. When you are clicking these entries WingBee makes normal cell call to correspondent callback number. The server accepts request and call you back.

WingBee can support also call-in method of call invocation.

This method can be selected through Settings panel – Transport mode:



At the same page you can activate “Fallback to cell” and Autoupdate mode for your entire web based data (recent calls, contacts, favorites)

## Usage of remote data

WingBee allows downloading following data:

- Web-based favorites entries
- Fast callback entries
- Call history (Recent calls)
- Web-based contacts.

It can be done through “Refresh” button (small circle on right-top of toolbar).

Web-based favorites before and after update:



Recent calls before and after update:



Fast callbacks before and after update:



Web Contacts before and after update:



Selected web contact can be imported into local Contacts database. To do this you need to press “+” button:



## Account modifications

If necessary you can change:

- Your credential
- Your Distributor
- Your current call-in number
- Your current transport

To do this you should use "Account" entry from "More..." section:



Call-in numbers can be selected from the list of available for current Distributor:

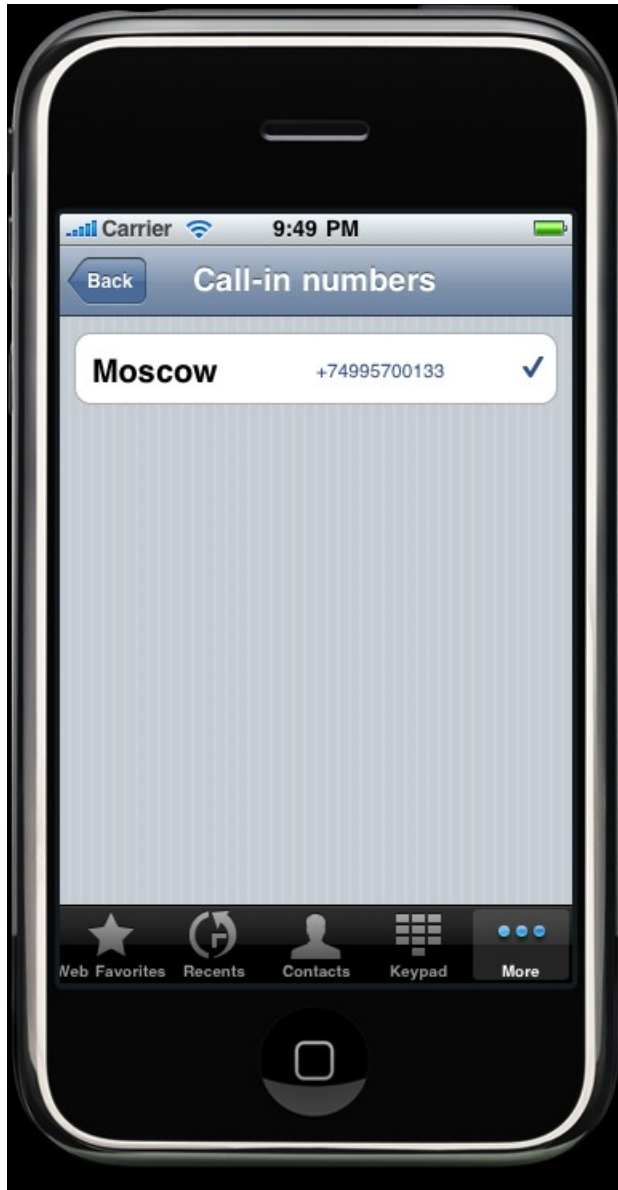

In the same way you can change your call invocation method from data callback to call in.